

GE SB 48-IN NEON FLEX LED DEER

ASSEMBLY INSTRUCTIONS

NHL Model No. 82003LO



Assembly Parts

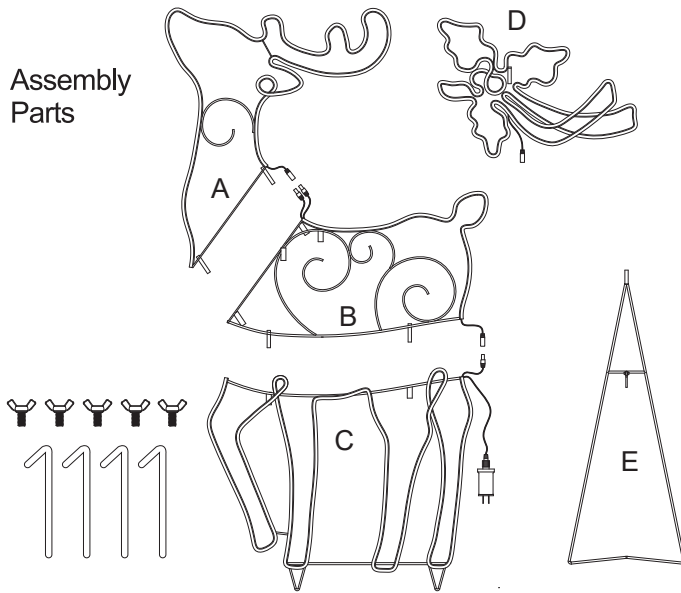

Step 1: Insert part B into C according to the figure, and tighten the screw to lock. Connect the male and female power cables.

Step 2: Insert B into part E according to the figure, and tighten the screw to lock. Insert the hook into the hole.

Step 3: Insert part A into B according to the figure, and tighten the screw to lock. Connect the male and female power cables.

Step 4: Insert part D into B according to the figure, and tighten the screw to lock. Connect the male and female power cables.

Step 5: Fix the four stakes at E and C according to the figure.

Step 1

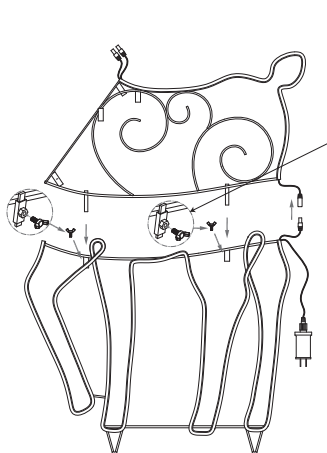

Step 2

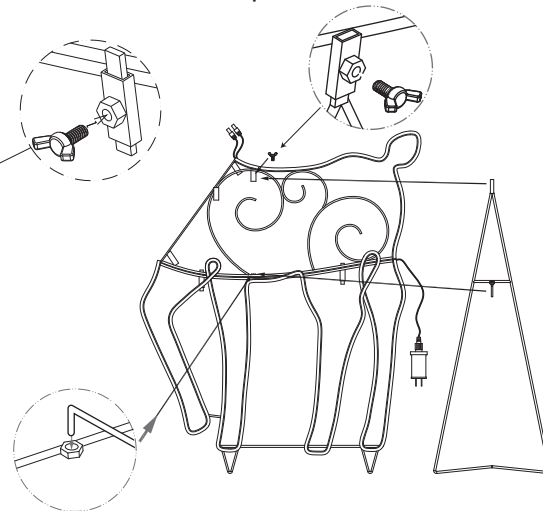

Step 3

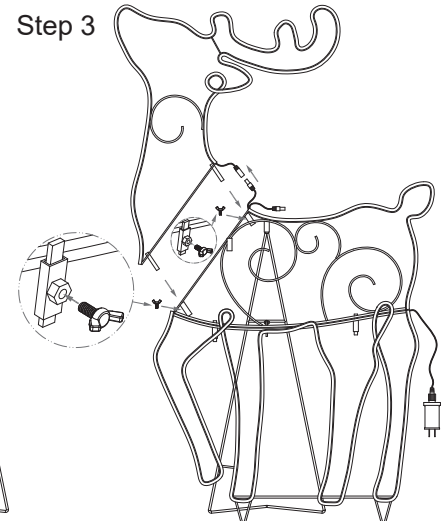

Step 4

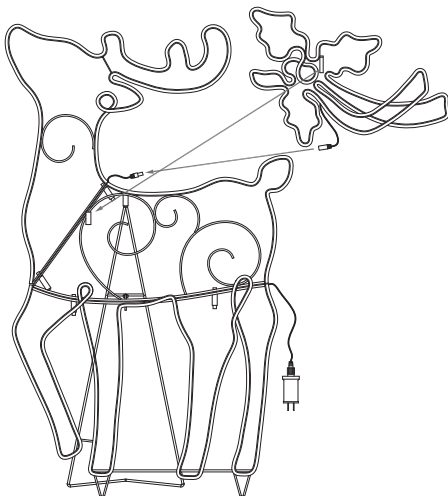

Step 5

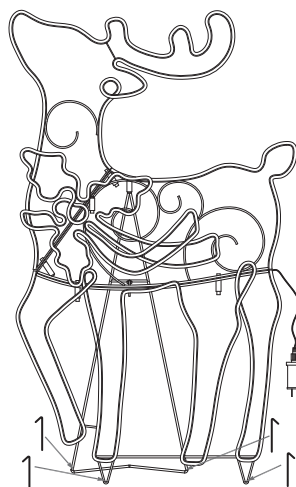

Assembly Complete

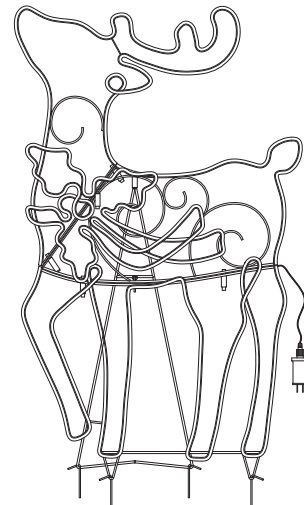

GE SB 48" NEÓN CURVO CIERVO

INSTRUCCIONES DE ENSAMBLAJE

NHL Modelo No. 82003LO



Piezas de ensamblaje

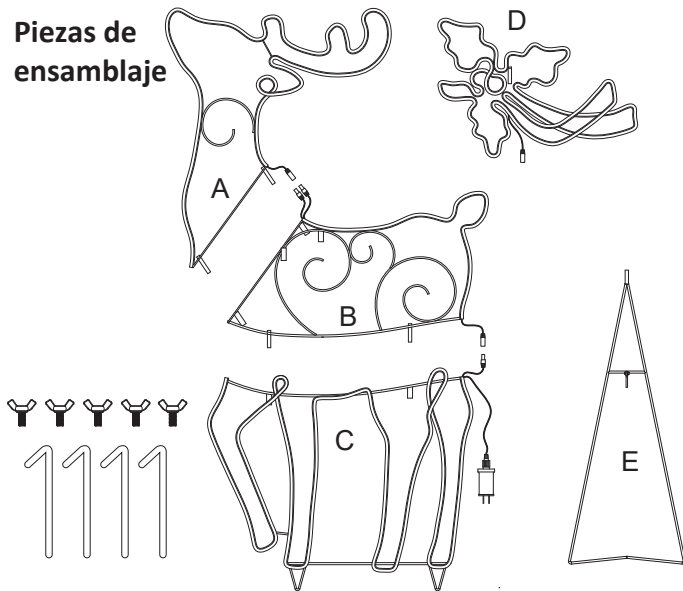

Paso 1: Insertar la parte B en C de acuerdo con la figura, y apretar el Tornillo a cerrar. Conecte los cables de alimentación macho y hembra.

Paso 2: Insertar B en la parte E de acuerdo a la figura, y apretar el Tornillo a cerrar. Inserte el gancho en el agujero.

Paso 3: Insertar la parte A en B de acuerdo con la figura, y apretar el Tornillo a cerrar. Conecte los cables de alimentación macho y hembra.

Paso 4: Acuerdo con la figura, y apretar el Tornillo a cerrar. Conecte los cables de alimentación macho y hembra.

Paso 5: Fijar las cuatro estacas en E y C según la figura.

Paso 1

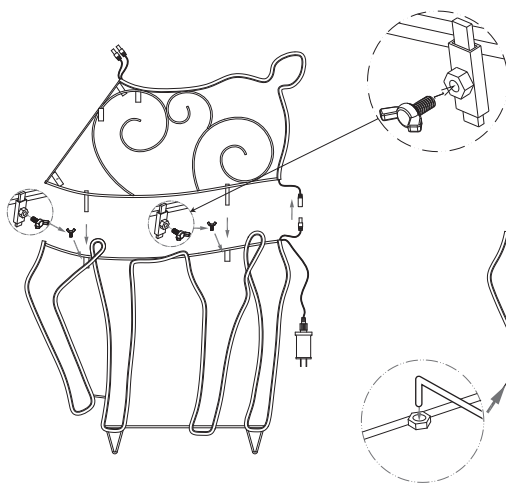

Paso 2

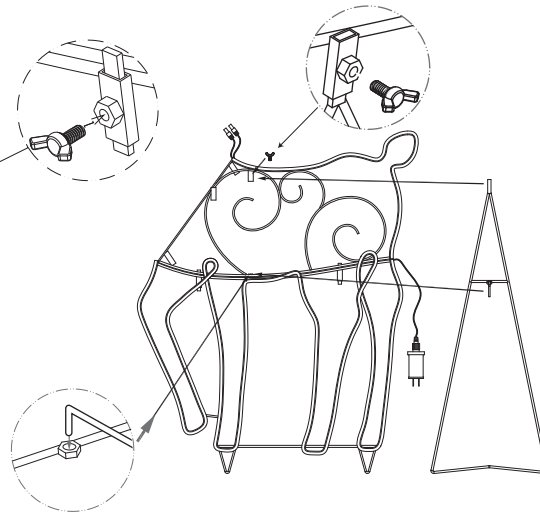

Paso 3

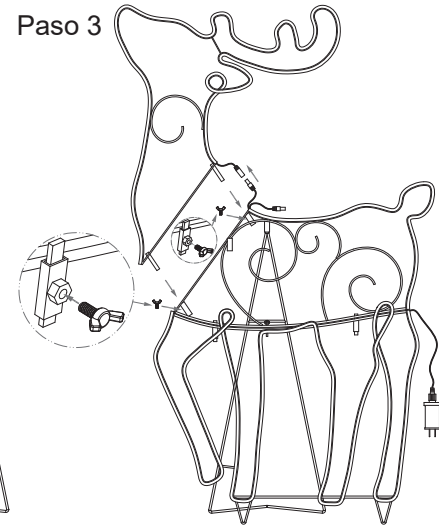

Paso 4

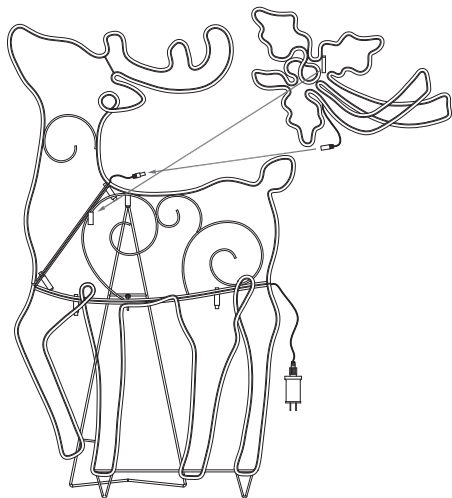

Paso 5

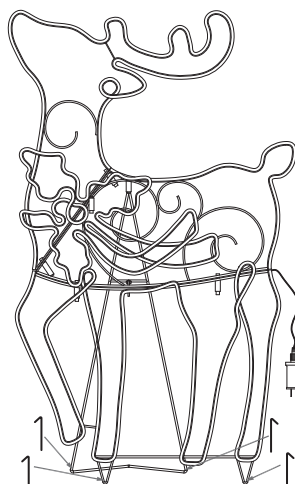

Ensamblaje completado

