

ITM. / ART. 1900373

IMPORTANT SAFETY INSTRUCTIONS

LED 3PK 150L (3X50) 5.5" RS SUPER SPHERE Model:99376(0.06)

When using electrical products, basic precautions should always be followed including the following:

READ AND FOLLOW ALL SAFETY INSTRUCTIONS CAUTION:

- To reduce the risk of fire and electric shock:
 - Do not install on trees having needles, leaves or branch coverings of metal or materials which look like metal, and
 - Do not mount or support strings in a manner that can cut or damage wire insulation.

- To reduce the risk of overheating, replace burned out lamps promptly. Use 3.3 volt, 0.066 Watt LED lamps only.
- This is an electrical product - not a toy! To avoid the risk of fire, burns, personal injury and electric shock it should not be played with or placed where small children can reach it.
- This product is equipped with non-shunted LED type lamps. Do not twist lamps. Push straight in or pull out to avoid damage.
- Do not use seasonal products outdoors unless marked suitable for indoor and outdoor use. When products are used in outdoor applications, connect the product to a Ground Fault Circuit Interrupting (GFCI) outlet. If one is not provided contact a qualified electrician for proper installation.
- This seasonal use product is not intended for permanent installation or use.
- Do not mount or place near gas or electric heaters, fireplaces, candles or other similar sources of heat.

- Do not secure the wiring of the product with staples or nails, or place on sharp hooks or nails.
- Do not let lamps rest on the supply cord or on any wire.
- Unplug the product when leaving the house, when retiring for the night, or if left unattended.
- Do not use this product for other than its intended use.
- Do not hang ornaments or other objects from cord, wire, or light string.
- Do not place lighting string on carpeting, drapes, furniture, or allow it to contact vinyl siding while the power is on.
- Do not perform any maintenance or troubleshoot for bad or broken lamps while the power is on.
- Do not close doors or windows on the product or extension cord as this may damage the wire insulation.
- Do not cover the product with cloth, paper or any material not part of the product when in use.

- This product employs overload protection (fuse). A blown fuse indicates an overload or short-circuit situation. If the fuse blows, unplug the product from the outlet. Also unplug any additional strings or products that may be attached to the product. Replace the fuse as per the user servicing instructions (follow product marking for proper fuse rating) and check the product. If the replacement fuse blows, a short circuit may be present and the product should be discarded.
- Read and follow all instructions that are on the product or provided with the product.



SAVE THESE INSTRUCTIONS

USE AND CARE INSTRUCTIONS

- When the product is placed on a live tree, the tree should be well maintained and fresh. Do not place on live trees in which the needles are brown or break off easily. Keep the tree holder filled with water.
- If the product is placed on a tree, the tree should be well secured and stable.
- Before using, or reusing, inspect product carefully. Discard any products that have cut, damaged or frayed wire insulation or cords, cracks in the lampholders or enclosures, loose connections, or exposed copper wire.
- When storing the product, carefully remove the product from wherever it is placed, including trees, branches, or bushes, to avoid any undue strain or stress on the product conductors, connections and wires.
- When not in use, store neatly in a cool, dry location protected from sunlight.

Instructions for replacing bulbs: If a damaged or burned out bulb needs to be replaced, we recommend wearing gloves throughout the replacement process. While holding the sphere with one hand, grab the damaged bulb closest to the husk and gently pull straight up and out of the socket. Insert the spare replacement bulb that is provided with this product into the empty socket.

- CAUTION:** To reduce the risk of overheating, Replace with only GE 3.3 volt, 0.066 Watt LED type lamps (provided with product).
- Grip the base of the burned out LED and pull straight out of the socket. Hold replacement LED by its base and insert into the correct position inside the socket. Push base into socket all the way.

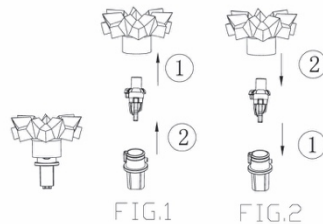

CAUTION:

- This lighting string is rated 7.2 Watts (0.06Amps), do not overload. Connect other lighting strings or decorative outfits end-to-end up to a maximum of 216 Watts (1.8 Amps) total. If connecting to a Lighting String that does not have a Wattage (W) rating, (found on the cord tag within 6 inches of the plug), calculate the wattage as follows: Multiply the current (A), which is on the flag-type tag by 120. For example: Lighting String is rated 120V, 60Hz, 0.2 Amps. $0.2 \times 120 = 24$ Watts. Add the wattage of each light string together for a total of 216 Watts or less. (Do not exceed 216 Watts.)

- To reduce the risk of overheating, a) replace burned out lamps promptly. Use 3.3 Volt, 0.066Watt LED lamps provided with this product. b) Risk of fire. This product does not contain lamp shunts in order to allow the product to operate if one lamp burns out. Do not replace lamps with other than the spare lamps provided with this product.

FUSE REPLACEMENT INSTRUCTIONS

Risk of fire. Do not replace attachment plug. Contains a safety device (fuse) that should not be removed. Discard product if the attachment plug is damaged. The most common reason for a fuse to blow is due to overload from too many sets being strung together.

- Make sure the light set is unplugged.
- To unplug, grasp plug and remove from the receptacle or other outlet device. Do not unplug by pulling the cord.
- Risk of fire. Replace fuse only with 125 volt, 3 amp fuse (provided with this product).
- Locate the fuse panel on the plug. Slide the panel open to expose the fuses inside (as shown).
- Remove fuse carefully. Replace the blown (darkened) fuse with the spare fuse included in this set. Close the panel completely by sliding the fuse access cover closed on top of attachment plug.

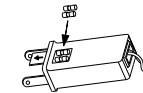

This device complies with Part 15 of the FCC Rules. Operation is subject to the following two conditions:

- this device may not cause harmful interference, and
- this device must accept any interference received, including interference that may cause undesired operation.

Warning: Changes or modifications to this unit not expressly approved by the party responsible for compliance could void the user's authority to operate the equipment.

NOTE: This equipment has been tested and found to comply with the limits for Class B digital device, pursuant to Part 15 of the FCC Rules. These limits are designed to provide reasonable protection against harmful interference in a residential installation. This equipment generates uses and can radiate radio frequency energy and, if not installed and used in accordance with the instructions, may cause harmful interference to radio or television reception, which can be determined by turning the equipment off and on, the user is encouraged to try to correct the interference by one or more of the following measures:
* Reorient or relocate the receiving antenna.
* Increase the separation between the equipment and the receiver.
* Connect the equipment into an outlet on a circuit different from that to which the receiver is connected.
* Consult the dealer or an experienced radio/TV technician for help.



For Indoor and Outdoor Use
120 V 60 Hz

Distributed by:
Costco Wholesale Corporation
P. O. Box 34535
Seattle, WA 98124-1535
USA
1-800-774-2678
www.costco.com
Made in China

For customer service call (English only):
1-866-489-0019

OPERATING HOURS: January 2 - November 9:
Monday to Friday, 10 AM - 7 PM EST, November 10 -
December 23: Monday to Friday, 8 AM - 8 PM EST,
Saturday & Sunday, 10 AM - 7 PM EST
December 24-29: 10 AM - 7 PM EST
See complete schedule at
www.geholidaylighting.com

Nicolas Holiday Inc.
204 Spring Hill Road
Trumbull, CT 06611

©2018 Nicolas Holiday Inc.,
9F., No. 37, Guangfu N. Rd
Taipei, Taiwan 10560
All rights reserved.

This is not a toy, for decorative use only.

IMPORTANT INFORMATION ABOUT YOUR LIGHTS

- This light set will continue to operate if an LED is burned out or loose. LEDs which become burned out or loose must be replaced promptly in order to maintain the performance and life expectancy of this set.
- It is important to replace burned out LEDs with those included with this set (3.3 volt, 0.066 watts). If LEDs from another set are used they may burn less brightly.

USER SERVICING INSTRUCTIONS

- If a number of LEDs are burned out, extra stress is put on the remaining LEDs in the circuit. This may cause additional LEDs to burn out prematurely.
- LED REPLACEMENT INSTRUCTIONS-** Use the LEDs provided with this product, follow these steps:
 - Make sure the light set is unplugged.
 - To unplug, grasp plug and remove from the receptacle or other outlet device. Do not unplug by pulling the cord.